

AUBO-C5

C Series Collaborative Robot



5KG
Payload



24KG
Weight



±0.1mm
Repeatability



886.5mm
Working Radius

- ✓ **AUBO-C5** Meets lightweight operation needs in emerging retail and other fields
- ✓ 5 kg payload, 1008.5 mm arm reach, max working radius 886.5 mm
- ✓ Compact and lightweight, small footprint, widely applicable

Application Areas

Applicable to emerging scenarios such as New Retail and service industries.



Rich Interfaces
Multi-functional End Effector

Wireless Teaching
Android-based Mobile Teaching Software



Lightweight Design
Highly Integrated Control Cabinet



Features & Advantages

- 01 Lightweight and Compact Design for Easy Deployment** Robot body occupies minimal space with quick deployment; Highly integrated control cabinet supports upright/sideways mounting.
- 02 Rich Interfaces for Seamless Integration** Control cabinet equipped with multiple interfaces. Tool end supports universal I/O, analog I/O, and 0/12/24V power supply.
- 03 Cost-Effective with High ROI** Average 3-9 ROI cycle months; Supporting optional accessories like tablets.
- 04 High Performance Tailored to Business Needs** 5 kg payload capacity and ±0.1 mm repeatability. Commercial-grade performance tailored to meet the integrated needs of business applications with seamless compatibility.
- 05 Intuitive Operation and Quick Learning Curve** Supports ARCS wireless teaching software. Equipped with portable operating handle.
- 06 Rapid Customization and Deployment** Supports color/logo customization. Software provides multi-level open interfaces.



High Performance



High Precision



Rapid Response



Safe and Stable



Modular Design



Flexible Production



Fine Workmanship



High Protection Level



Compact and Portable



Others

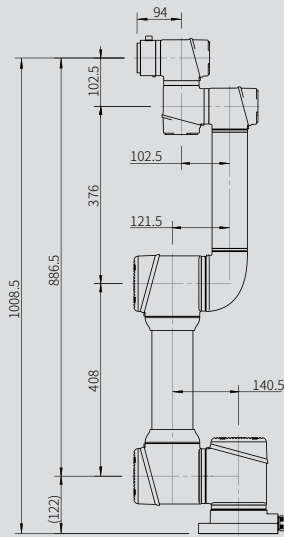

AUBO-C5 Dimensions Drawing

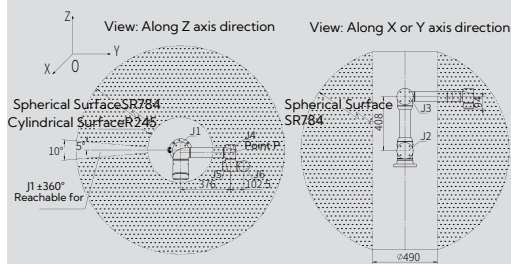

AUBO-C5 P-Point Motion Range

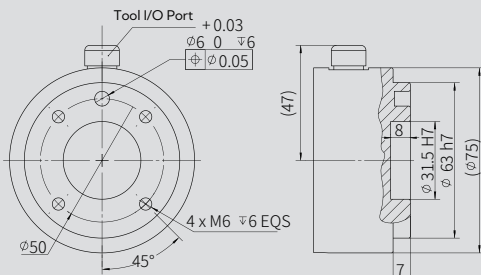

AUBO-C5 End Flange

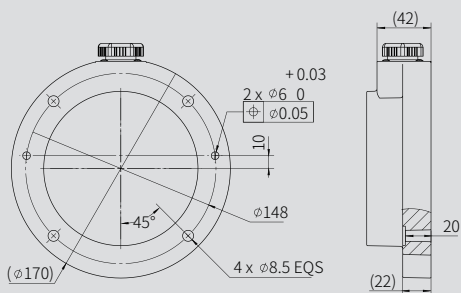

AUBO-C5 Base Top View

Robot

| | |
|------------------------------|-------------------------|
| Degrees of Freedom | 6-axis |
| Maximum Reach | 886.5 mm |
| Payload | 5 kg |
| Weight | 24 kg |
| Installation Flange Diameter | 0170 mm |
| Repeatability | ±0.1 mm |
| Tool Speed | ≤2.8 m/s |
| Average Power | 200 W |
| Peak Power | 600 W |
| Operating Temperature | 0-50°C |
| Operating Humidity | 90% RH (non-condensing) |
| Installation Method | Any angle |
| IP Rating | IP54 |
| Cleanroom Classification | ISO 14644-1 Class 5 |

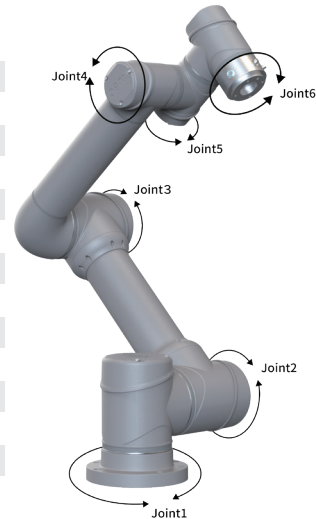

Joint Motion Parameters

| | Motion Range(°) | Maximum Speed (°/s) |
|---------|-----------------|---------------------|
| joint 1 | ±360 | 147 |
| joint 2 | ±360 | 147 |
| joint 3 | ±162 | 147 |
| joint 4 | ±360 | 178 |
| joint 5 | ±360 | 178 |
| joint 6 | ±360 | 178 |

*Note: Joints support ±360° rotation but may be restricted by application scenarios.

Control Box

| | |
|----------------------------|--|
| Model | AUBO-CB-C |
| Dimensions | 350mm*280mm*100mm |
| Weight | 6.5kg |
| Robot Arm Cable Length | 5m |
| Teach Pendant Cable Length | 2.5m (Control Handle) |
| Power Cable Length | 5m |
| Communication Protocols | Ethernet, Modbus-RTU/TCP (Optional: EtherCAT, Ethernet/IP, Profinet) |
| Interface | SDK(C++/Python/JavaScript Windows + Linux), supports ROS/ROS2 |
| Input Power Supply | 100-240VAC, 50-60Hz |
| Protection Rating | IP30 |



Control Box IO/Tool End IO

| | | Control Box Side | Tool End Side |
|------------------|---------------------|-----------------------------------|--------------------|
| I/O Interface | Digital Input | 8 (Expandable) / 8 (Safety-rated) | 4 (Configurable) |
| | Digital Output | 8 (Expandable) / 8 (Safety-rated) | 4 (Configurable) |
| | Analog Input | 2 | 2 |
| | Analog Output | 2 | - |
| | RS485 Communication | 1 | 1 |
| I/O Power Supply | Output Voltage | 24V | 0V/12V/24V |
| | Output Current | 2A | Rating 2A, Peak 3A |

Teach Pendant

| | |
|------------|----------------------|
| Model | AUBO-TP-C |
| Dimensions | 254mm*213.1mm*40.8mm |
| Weight | 1.0kg |
| IP Rating | IP43 |
| Color | White |

